

VENTILATION MAP LEGEND

Operable windows: Where no mechanical ventilation is present, windows should be used to increase fresh air.

Mechanical ventilation: Ventilation is managed by HVAC/BMS. May also have operable windows which can be used in conjunction.

Note. White spaces are to be used in accordance with COVID-19 requirements and current health advice.

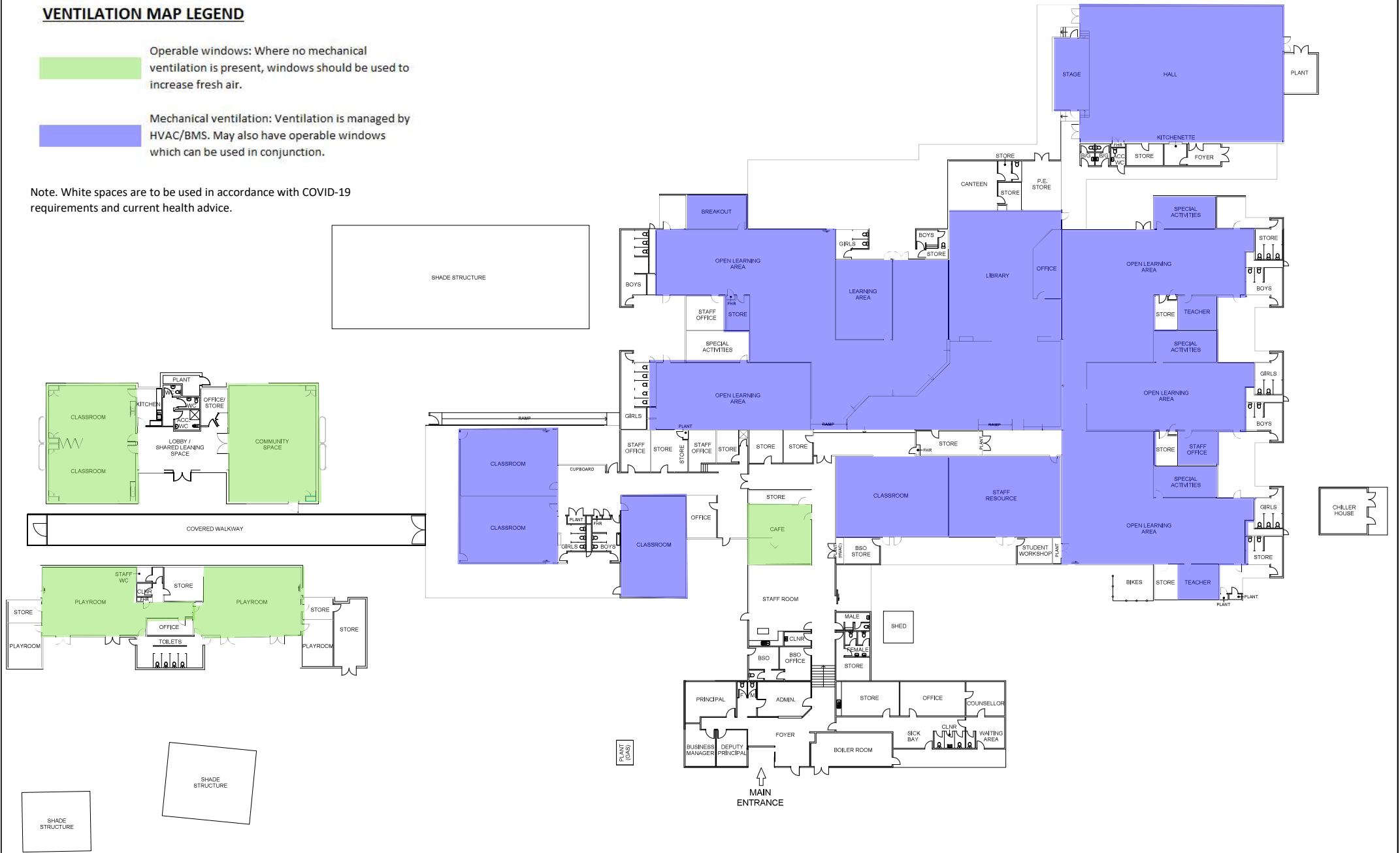

ISSUE	AMENDMENT	DRAWN	VERD	APPD	DATE

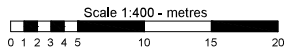

SCALE
1:400
DATE
FEB 2017
DRAWING SHEET SIZE = A3



PROJECT
CHARNWOD DUNLOP SCHOOL
INFRASTRUCTURE & CAPITAL WORKS
SCHOOL LAYOUT PLAN